

## 1. Attach the Baseplate

Flip over the main part of your Emerge II unit to attach the baseplate to the bottom. Use 8 screws to secure the baseplate.



## 2. Build the Arm

Flip the provided work surface upside down then attach the arm to the work surface. This will use 5 screws.

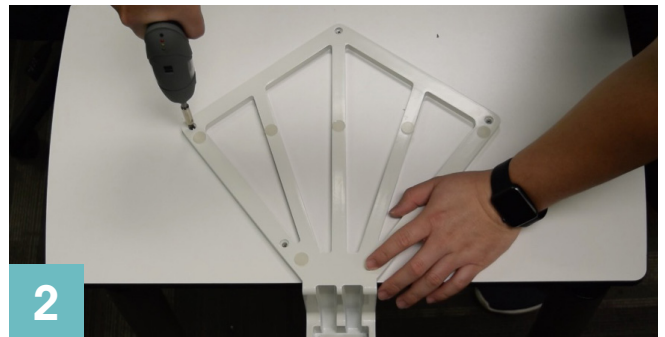

## 3. Attach the Arm

Slide the arm over the top of the main unit. There will be four holes at the bottom of the main unit that align with the arm to attach it.



## 4. Secure the Top Plate

**Single Monitor Unit** - Mount the top plate and monitor to the provided VESA mount, then skip to step 8.



**Multiple Monitor Units** - If you are using a multiple monitor system, attach the top plate, then secure the monitor arm pole to the plate. Once complete continue to step 5.



Single Mount

Multi Mount

## 5. Multiple Monitor Mount

If you are mounting multiple monitors. You will continue by attaching the Mounting Pole to the top plate from step 4.



## 6. Slide on and Secure Arm

Once the Mounting Pole is secure, slide on the Arm System from below, then install the safety screw.

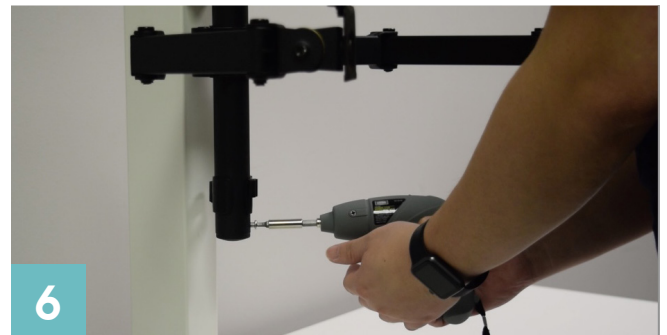

## 7. Secure VESA Monitors

Attach the VESA Mounts to your monitors, then slide them overtop the mounts on the arm system. Secure each monitor with a screw cap.

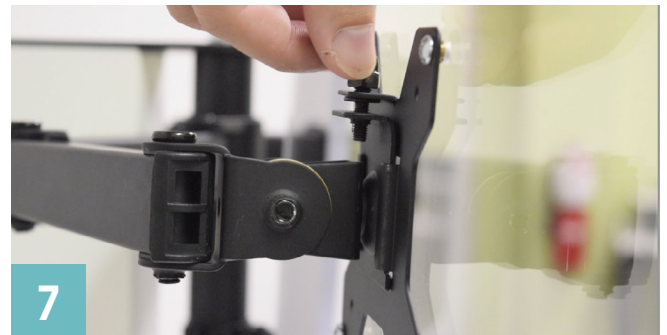

## 8. Power up your Emerge II

Plug in your Emerge II unit and press the buttons on the provided remote to ensure everything is working properly.

